

# ROSCOMMON COUNTY

500 Lake Street.  
Roscommon, MI 48653

Phone: (989) 275-8323  
Fax: (989) 275-5675

## SOIL EROSION AND SEDIMENTATION POLLUTION CONTROL APPLICATION FEE SCHEDULE

Effective January 1, 2006

### APPLICATION FEE AS FOLLOWS:

RESIDENTIAL PERMIT (includes plan review and site visit)	\$140.00
COMMERCIAL – INDUSTRIAL APPLICATION FEE	\$300.00
Plan review (non-refundable)	100.00
Site Visits – each (to be determined by Soil Erosion Officer)	50.00
PONDS AND SOIL STRIPPING – up to one acre	\$150.00
Plan review (non-refundable)	50.00
Site Visits - each (to be determined by Soil Erosion Officer)	50.00
Each additional acre or fraction thereof	50.00

(MAKE CHECK PAYABLE TO ROSCOMMON COUNTY)

**FINAL PERMIT WILL NOT BE ISSUED UNTIL ALL FEES ARE  
PAID IN FULL.**

**ROSCOMMON COUNTY  
SOIL EROSION AND  
SEDIMENTATION CONTROL  
APPLICATION for Part 91  
500 LAKE STREET  
ROSCOMMON, MI 48653  
PHONE (989)275-8323  
FAX (989)275-5675**

**OFFICE USE ONLY**

Permit Number
Date Issued
Expiration Date
File Number

**1. APPLICANT** (Please check if applicant is the landowner or designated agent\*)

Name <input type="checkbox"/> Landowner <input type="checkbox"/> Designated Agent			
Address			
City	State	Zip Code	Area Code/Telephone Number

**2. LOCATION**

Section	Town	Range	Township	City/Village	County
Subdivision	Lot No.	Tax ID Number		Street Address	

**3. PROPOSED EARTH CHANGE**

Project Type:  Residential  Multi-family  Commercial  
 Industrial  Land Balancing

Describe Project		Size of Earth Change (acres or square feet)
Name of and Distance to Nearest Lake, Stream, or Drain	Date Project to Start	Date Project to be Completed

**4. SOIL EROSION AND SEDIMENTATION CONTROL PLAN** (Refer to Rule 323.1703)

<b>Note: ___complete sets of plans must be attached.</b>	Estimated Cost of Erosion and Sediment Control	
	Plan Preparer's Name and Telephone Number	Area Code ( )

**5. PARTIES RESPONSIBLE FOR EARTH CHANGE**

Name of Landowner (if not provided in Box No. 1 above)		Address	
City	State	Zip	Area Code/Telephone Number
Name of Individual "On Site" Responsible for Earth Change		Company Name	
Address	City	State	Zip Code
		Area Code/Telephone Number	

**6. PERFORMANCE DEPOSIT** (If required by the permitting agency)

Amount Required \$ _____	<input type="checkbox"/> Cash	<input type="checkbox"/> Certified Check	<input type="checkbox"/> Irrevocable Letter of Credit	<input type="checkbox"/> Surety Bond
Name of Surety Company				
Address	City	State	Zip Code	Area Code/Telephone No.

**7. DIRECTIONS TO SITE**

I (we) affirm that the above information is accurate and that I (we) will conduct the above described earth change in accordance with Part 91, Soil Erosion and Sedimentation Control, of the Natural Resources and Environmental Protection Act, 1994 PA 451, as amended, applicable local ordinances, and the documents accompanying this application.

Landowner's Signature	Print Name	Date
Designated Agent's Signature*	Print Name	Date

\* Designated agent must have a written statement from landowner authorizing him/her to secure a permit in the landowner's name.

## ROSCOMMON COUNTY SESC APPLICATION

### THE FOLLOWING ITEMS ARE REQUIRED BY PART 91 OF THE NATURAL RESOURCES AND ENVIRONMENTAL PROTECTION ACT PRIOR TO OBTAINING A PERMIT

- 1) SITE LOCATION SKETCH (SHOWING THE SITE AND IMMEDIATE SURROUNDING ROADS).
  - 2) MAP (PLAN) DRAWING WITH NORTH ARROW SCALED TO NOT OVER 200' PER INCH (INCLUDE ITEMS BELOW)
  - 3) DISTANCE FROM THE EARTH CHANGES IN FEET TO NEAREST LAKE, STREAM OR OTHER WATER.
  - 4) LAND FEATURES (SHOW HILLS, DITCHES, ETC.)
  - 5) EXISTING AND PROPOSED CONTOUR INTERVALS IF ANY, AND SLOPE DIRECTION WITH ARROWS, UNLESS FLAT.
  - 6) FULL PHYSICAL LIMITS OF EACH PROPOSED EARTH WORK/GRADING CHANGE-NOT JUST FOUNDATIONS
  - 7) SOILS INFORMATION / WRITTEN DESCRIPTION (SAND/CLAY/OTHER).
  - 8) A DESCRIPTION AND THE LOCATION OF ALL EXISTING AND PROPOSED DRAINAGE FACILITIES (CULVERTS, ETC.)
  - 9) EARTHWORK SCHEDULE (BREAKING GROUND, GRADING, TO FINAL SEEDING, ATTACH SEPARATE PAGE IF NEC.)
  - 10) A DESCRIPTION AND LOCATION FOR INSTALLING AND REMOVING ALL PROPOSED TEMPORARY SESC MEASURES (SILT FENCE, MULCH BLANKET, ETC.)
  - 11) A DESCRIPTION AND LOCATION OF ALL PROPOSED PERMANENT SESC MEASURES (SEEDING, RIP RAP, ETC.)
  - 12) A WRITTEN MAINTENANCE PROGRAM (WATERING OF SEED, CLEANING OF CATCH BASINS, ETC.) INCLUDING PERSON RESPONSIBLE FOR MAINTENANCE (OWNER, CONTRACTOR, ETC).
- ATTACH ADDITIONAL DESCRIPTION SHEETS AS NECESSARY

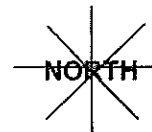

SIGNATURE:

DATE:

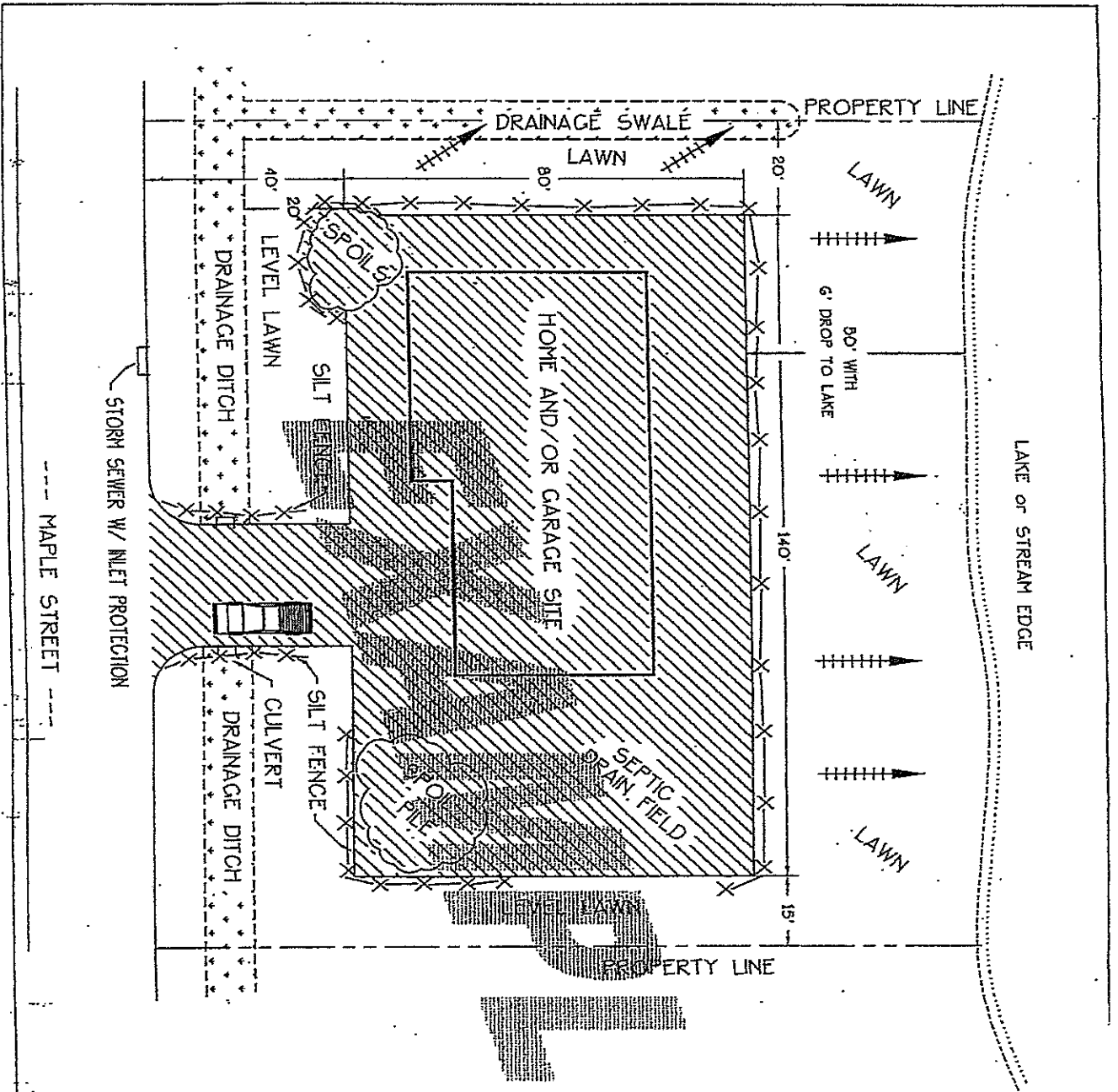

SOILS TYPE:  
SANDY LOAM

**SYMBOLS LEGEND:**

INDICATES DIRECTION OF SLOPE



INDICATES AREA OF EARTH CHANGE

INDICATES SILT FENCE LOCATION

**CROSS SECTIONS:**

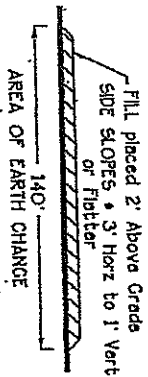
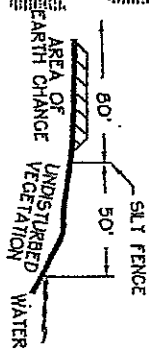

**CONSTRUCTION SCHEDULE:**

- 6/15/05 INSTALL PERIMETER SEDIMENT CONTROLS
- 6/17/05 GRADE SITE
- 6/17/05 - 9/10/05 CONSTRUCTION OF BUILDING
- 9/15/05 PAVING
- 9/15/05 - 9/20/05 FINAL GRADE, SEED + MULCH
- REMOVE TEMPORARY PERIMETER CONTROLS WHEN VEGETATION IS ESTABLISHED.

POINT # 123456  
SHEET 1 OF 1

PROPERTY OWNER: SALLY PUBLIC RESPONSIBLE PERSON: JOHN DOE  
PROJECT LOCATION: 123 OAK ST. ABC TWP PHONE NUMBER: 995-6042  
EXAMPLE OF A SOIL EROSION & SEDIMENTATION CONTROL PLAN

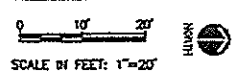

# ROSCOMMON COUNTY SOIL EROSION

500 Lake Street  
Roscommon, MI 48653

Phone: (989) 275-8323  
Fax: (989) 275-5675

Effective immediately, the State requires each Authorized Agent applying for a Soil Erosion Permit on behalf of another person to include a Statement authorizing him/her to secure permit. Please have the landowner complete this Letter of Authorization to be submitted with the application.

## LETTER OF AUTHORIZATION

\_\_\_\_\_ is authorized to secure a Soil Erosion  
(Name of Designated Agent)

Erosion Permit in my name for a project requiring said permit at \_\_\_\_\_  
(Address of

\_\_\_\_\_  
Project Location.)

\_\_\_\_\_  
(Print name of Landowner)

\_\_\_\_\_  
(Signature of Landowner)

\_\_\_\_\_  
(Date)